



## Daisetsuzan National Park



### Daisetsuzan National Park

Designated in 1934, Daisetsuzan National Park is Japan's largest mountain national park at around 230,000 hectares. The park features stunning landscapes ranging from majestic mountains to beautiful wetland, and was designated to protect the unspoiled nature and precious flora and fauna, including species that can only be found in this area.

It is our duty and our right to preserve these magnificent natural landscapes and the flora and fauna that live there for future generations, and to nurture the life in the Daisetsuzan mountains to enable further growth. Treating nature with respect is of the utmost importance when enjoying a park like this.



### Sounkyo Visitor Center

Sounkyo Visitor Center is a one-stop facility to help you explore the nature in Daisetsuzan National Park. We give nature talks, lead nature experiences, carry out various activities to preserve the natural environment and provide the latest information on Sounkyo and the Daisetsuzan area.



The parking spaces by the center are disabled parking only. Standard parking areas are marked on the map with the **P** symbol.

	Sapporo Interchange	Hokkaido Expressway	Kamikawa-Sounkyo Interchange	National Highway Route 39	
		2 hr		30 mins	
	Sapporo	JR	Asahikawa	1 hr 50 mins by Dohoku bus	
		1 hr 25 mins		1 hr 30 mins by taxi	
	Sapporo	JR	Asahikawa	JR	
		1 hr 25 mins		50 mins	
			Kamikawa	30 mins by bus	
				20 mins by taxi	

### Center information

- Opening hours  
June – October: 8:00am – 5:30pm / November – May: 9:00am – 5:00pm
- Closures  
June – October: Open every day / November – May: Closed Mondays.  
(If Monday is a public holiday, the center closes on the next business day instead.)  
The center also closes from December 31 to January 5 at the New Year.
- Admission : FREE

### Sounkyo Visitor Center

Sounkyo, Kamikawa Town, Kamikawa District, Hokkaido 078-1701  
Phone: 01658-9-4400 Fax: 01658-9-4401  
<http://sounkyovc.net>

March 2021



## Sounkyo Visitor Center Daisetsuzan National Park

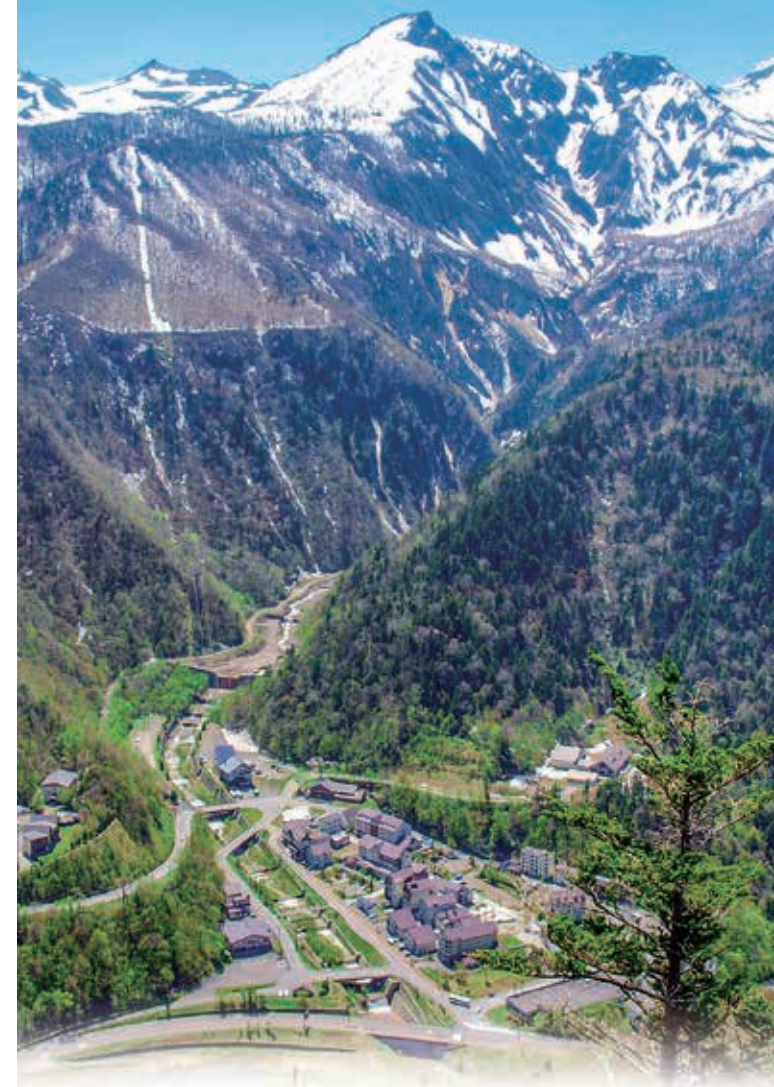

Ministry of the Environment  
Hokkaido Regional Environmental Office



# Welcome to Souunkyo Visitor Center!



## F Vast fields of flowers

High altitudes create another world—venture up the Daisetsuzan mountains and you'll see flower fields and alpine butterflies that can't be found closer to sea level. This exhibit tells you everything you need to know about the windswept earth, Siberian dwarf pine forests, snowy fields and wetlands created by late-melting snow in the upper reaches of the mountains, and the plants and butterflies found there.



Komakusa (*Dicentra peregrina*)



Eversmann's Parnassian butterfly

## E Hiking guide

This section tells you about the four main nature trails in Daisetsuzan National Park. Check out real-time information on the nature and find out the highlights of each trail before you set off.



## G Columnar joints

Ohachidaira Caldera, the caldera in the center of the park, was formed by an eruption around 30,000 years ago. During the eruption, a large amount of volcanic ash and small stones filled the watershed of the Ishikari River. As this sediment cooled, orderly cracks called columnar joints were formed. Over the centuries, the fierce current of the Ishikari River wore these down, creating the gorge you see today.



## A VR Monitor System

This monitor system and goggles offer you virtual reality experiences to trail hiking, variety of activities and aerial images of Daisetsuzan National Park.

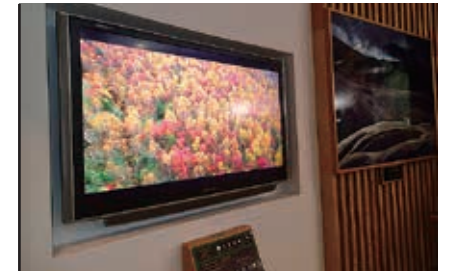

## B High-definition videos

Discover the secrets of Souunkyo Gorge and winter, spring, summer and fall in the Daisetsuzan mountains.

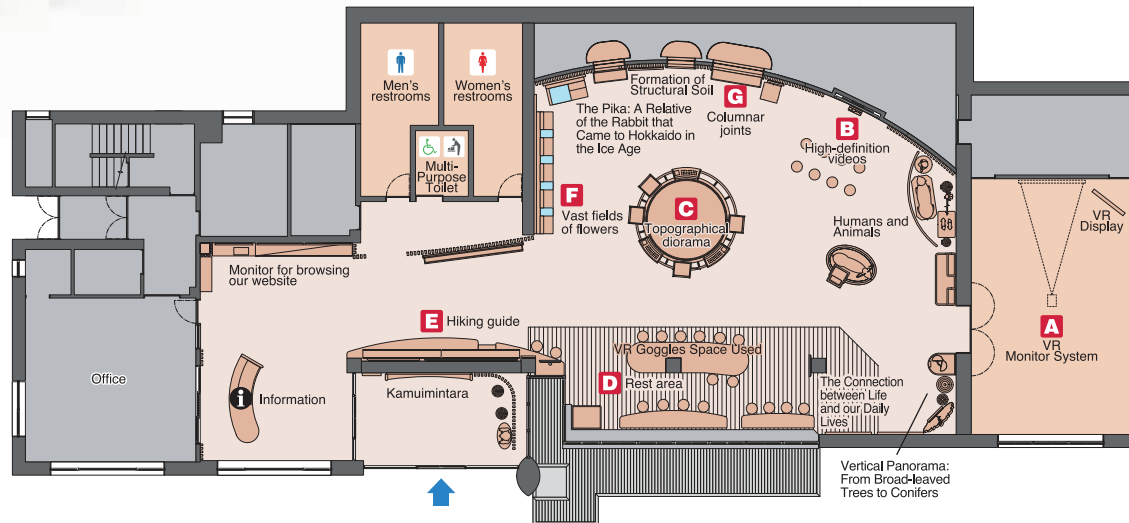

## D Rest area

Sit at a table with your travel companions and talk about the things you'd like to see, or step out onto the terrace and admire Souunkyo Gorge. The goggles for VR monitor system can be used in this area.



## C Topographical diorama

This diorama shows the topography of the Daisetsuzan mountains. See a bird's eye view of the main mountains, trails, emergency cabins, campgrounds and hot springs, along with snowy ravines that can be seen as late as early July.

